

COMPACT TYPE SP SERIES GEARED MOTOR

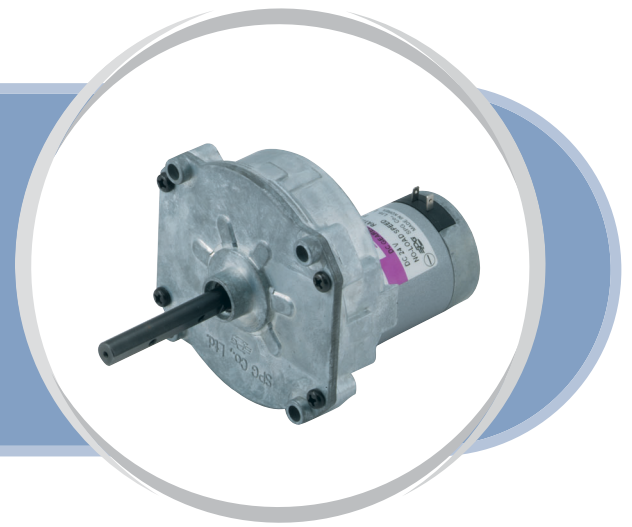

MOTOR DIMENSION

UNIT : mm[inch]

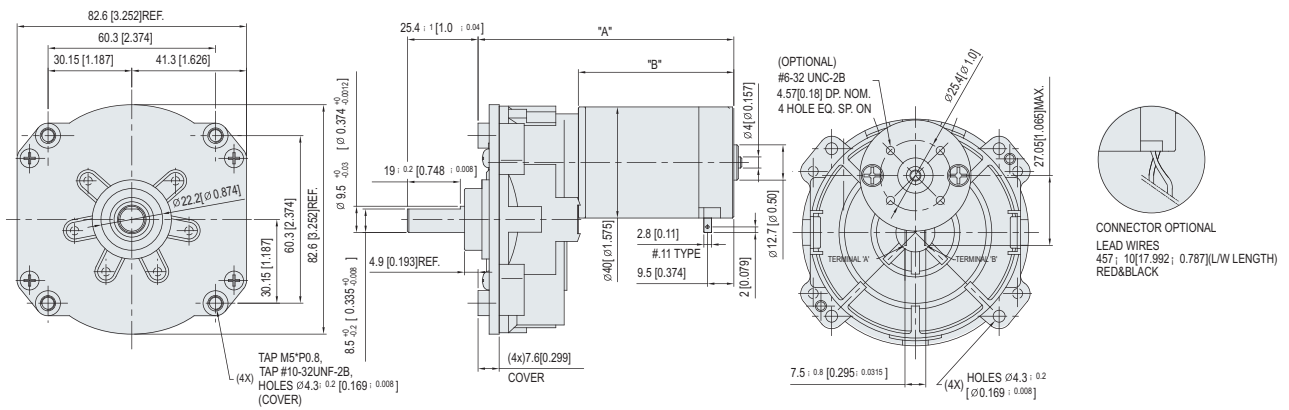

MODEL NO.	"A"	"B"
SP42□□□□	82.5 [3.248]	46.4 [1.827]
SP43□□□□	92.1 [3.626]	56.0 [2.205]
SP44□□□□	97.2 [3.827]	61.1 [2.406]

MODEL NO.	"A"	"B"
SP45□□□□	104.8 [4.126]	68.7 [2.705]
SP46□□□□	113.7 [4.476]	77.6 [3.055]

PERMISSIBLE TORQUE OF GEAR BOX

(Voltage : DC 24V)

TYPE	GEAR RATIO	32.4	73.5	148.8	253	747.5	3105.2
SP42B□□□	No Load rpm	216.5	95.4	47.1	27.7	9.4	2.3
	N·m	0.37	0.84	1.53	2.60	6.92	11.27
	oz·in	52.5	118.9	216.8	368.6	980.0	1595.8
	kgf·cm	3.78	8.57	15.62	26.56	70.62	115.00
SP43B□□□	No Load rpm	185.0	81.5	40.3	23.7	8.0	1.9
	N·m	0.76	1.73	3.16	5.37	11.27	11.27
	oz·in	108.1	245.3	447.1	760.2	1595.8	1595.8
	kgf·cm	7.79	17.68	32.22	54.78	115.00	115.00
SP44B□□□	No Load rpm	189.8	83.7	41.3	24.3	8.2	2.0
	N·m	1.00	2.03	4.11	7.00	11.27	11.27
	oz·in	141.0	287.8	582.5	990.5	1595.8	1595.8
	kgf·cm	10.16	20.74	41.98	71.38	115.00	115.00
SP45B□□□	No Load rpm	195.9	86.4	42.7	25.1	8.5	2.0
	N·m	1.13	2.57	4.69	7.97	11.27	11.27
	oz·in	160.6	364.3	663.9	1128.7	1595.8	1595.8
	kgf·cm	11.57	26.25	47.84	81.34	115.00	115.00
SP46B□□□	No Load rpm	151.7	66.9	33.0	19.4	6.6	1.6
	N·m	1.57	3.57	6.51	11.06	11.27	11.27
	oz·in	222.9	505.7	921.3	1566.4	1595.8	1595.8
	kgf·cm	16.06	36.44	66.39	112.88	115.00	115.00

* 기타 감속비는 별도 협의